

DIN 6916

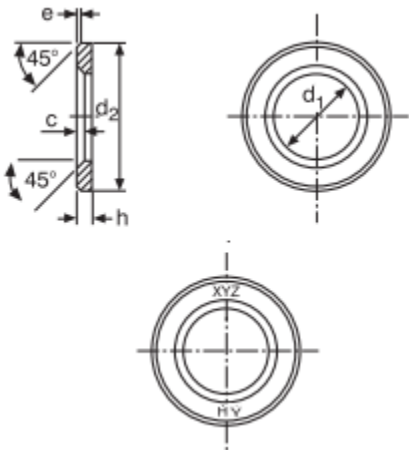

Nominal size <i>d</i>	Inside Diameter <i>d1</i>		Outside Diameter <i>d2</i>		Thickness <i>h</i>		External Chamfer <i>e</i>		Internal Chamfer <i>c</i>	
	max.	min.	max.	min.	max.	min.	max.	min.	max.	min.
M12	13.27	13.00	24.00	23.48	3.30	2.70	1.00	0.50	1.90	1.60
M16	17.27	17.00	30.00	29.48	4.30	3.70	1.50	0.75	1.90	1.60
M20	21.33	21.00	37.00	36.38	4.30	3.70	1.50	0.75	2.50	2.00
M22	23.33	23.00	39.00	38.38	4.30	3.70	1.50	0.75	2.50	2.00
M24	25.33	25.00	44.00	43.38	4.30	3.70	1.50	0.75	2.50	2.00
M27	28.52	28.00	50.00	49.00	5.60	4.40	2.00	1.00	3.00	2.50
M30	31.62	31.00	56.00	54.80	5.60	4.40	2.00	1.00	3.00	2.50
M36	37.62	37.00	66.00	64.80	6.60	5.40	2.50	1.25	3.00	2.50

DIN 6340

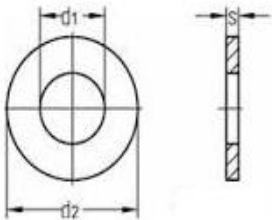

<i>d</i>	M 6	M 8	M 10	M 12	M 16	M 20	M 24	M 30
<i>d1</i>	6,4	8,4	10,5	13,0	17,0	21,0	25,0	31,0
<i>d2</i>	17,0	23,0	28,0	35,0	45,0	50,0	60,0	68,0
<i>s</i>	3,0	4,0	4,0	5,0	6,0	6,0	8,0	10,0

DIN 125B

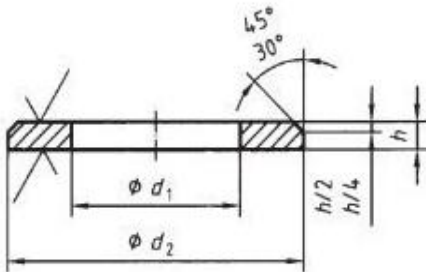

Nominal size (Nominal thread diameter, <i>d</i>)	Clearance hole <i>d1</i>		Outside diameter <i>d2</i>		Thickness <i>h</i>		
	nom.	max.	nom.	min.	nom.	max.	min.
10	10,50	10,77	20,00	19,48	2	2,2	1,8
12	13,00	13,27	24,00	23,48	2,5	2,7	2,3
16	17,00	17,27	30,00	29,48	3	3,3	2,7
20	21,00	21,33	37,00	36,38	3	3,3	2,7
24	25,00	25,33	44,00	43,38	4	4,3	3,7
30	31,00	31,39	56,00	55,26	4	4,3	3,7
36	37,00	37,62	66,0	64,8	5	5,6	4,4
42	45,00	45,62	78,0	76,8	8	9	7
48	52,00	52,74	92,0	90,6	8	9	7
56	62,00	62,74	105,0	103,6	10	11	9
64	70,00	70,74	115,0	113,6	10	11	9